

DS-D5165TS/P(B) Education Interactive Flat Panel



The Hikvision Education Flat Panel is a kind of newly developed intelligent teaching assistance product which integrates with the latest technologies of touch control, HD display, video processing, network communication, interactive control, sound control. It can be widely applied to the classroom, online teaching, training center, etc.

- UHD 4K display with resolution of 3840×2160
- Anti-glare and anti-blocking design to ensure smooth interaction
- Dual systems of Windows and Android saving cost and easy to use
- Quick response, at most 20-point touch control and smooth writing experience
- Local and USB files auto classified management, and quick search or manage office, audio, video, or picture files
- Dual USB interfaces, and data from any interface can be read in Windows and Android system at the same time
- All-in-one design with tempered glass and intelligent temperature control, making it environmental-friendly and safety-guaranteed

▪ Specification

Model		DS-D5165TS/P(B)
Product Model	Product Model	DS-D5165TS/P(B)
Display	Screen Size	64.5 inch
	Backlight	D-LED
	Pixel Pitch	0.372 (H) mm × 0.372 (V) mm
	Resolution	3840 × 2160
	Brightness	400 cd/m ²
	Color Depth	10 bit, 8bit+FRC
	Contrast Ratio	4000:1
	Response Time	6.5 ms
	Color Gamut	72% NTSC
	Refresh Rate	60 Hz
	Viewing Angle	178°(H)/178°(V)
Power	Power Consumption	≤ 390W(Full load)
	Standby Consumption	≤ 0.5 W
Working Environment	Working Temperature	0 °C to 40 °C (32 °F to 104 °F)
	Working Humidity	20% to 90% RH
General	Power Supply	100 to 240 VAC, 50/60 Hz
	Product Dimensions (W × H × D)	1498.43 (W) mm × 909.06 mm (H) × 88.6 (D) mm (58.99 " × 35.79 " × 3.49 ")
	Package Dimensions (W × H × D)	1696 (W) mm × 1070 (H) mm × 243 (D) mm (66.77 " × 42.12 " × 9.56 ")
	Net Weight	39.510 kg
	Gross Weight	53.450 kg
Built-in System	Operation System	Android 11
	Processor	A75*2+A55*2
	Memory	4G
	Built-in Storage	32G
	NIC	100Mbps
Touch	Touch Type	Infrared Touch Screen
	Glass	4mm Heat Tempered Glass 7H with Anti-Smudge and Anti-Glare for durability
	Touch Point	20 point multi-touch
	Touch Response Time	≤ 10 ms
	Touch Precision	± 1 mm (≥ 90% touching area)
Interface	Video & Audio Input	Type-C × 1, HDMI In × 1, LINE In × 1, VGA In × 1, AV In × 1, AV OUT × 1
	Video & Audio Output	Analog 2.0 Audio Line Out(3.5 mm jack) × 1, SPDIF OUT × 1
	Control Interface	TOUCH-USB × 1, RS232 × 1
	Network Interface	RJ45 (100 M bps) × 1, WIFI (Support AP+Station)
	Data Transmission Interface	USB 3.0 × 3, USB 2.0 × 1, TYPEC × 1(11 W)



Internal Function	Loudspeaker	Built-in 2 × 15 W loudspeaker
	Bluetooth	Built-in BLE (Bluetooth Low Energy) module supports Bluetooth 5.0

Physical Interface

Power Interfaces

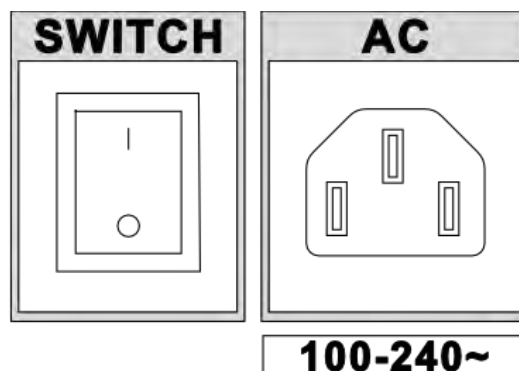

Interfaces	Description
SWITCH	
AC	

Side Interfaces



Interfaces	Description
TOUCH USB	TOUCH USB
AUDIO IN	AUDIO IN
VGA IN	VGA IN
USB 3.0	USB 3.0
USB 2.0	USB 2.0
HDMI IN	HDMI IN
HDMI OUT	HDMI OUT

Headquarters

No.555 Qianmo Road, Binjiang District,
Hangzhou 310051, China
T +86-571-8807-5998
www.hikvision.com



Follow us on social media to get the latest product and solution information.



Bottom Interfaces

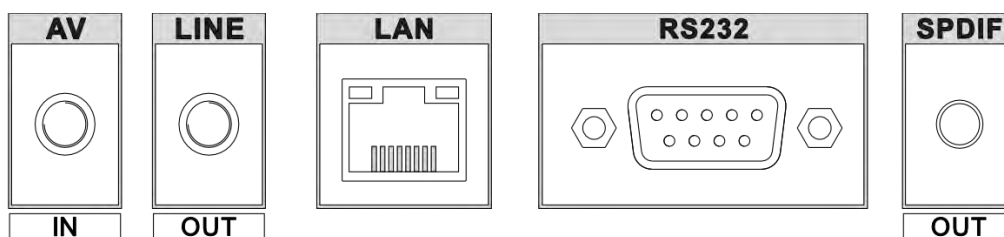

Interfaces	Description
AV IN	AV IN
LINE OUT	LINE OUT
LAN	LAN
RS232	RS232
SPDIF OUT	SPDIF OUT

Available Model

DS-D5165TS/P(B), DS-D5165TS/P(B)

Dimension

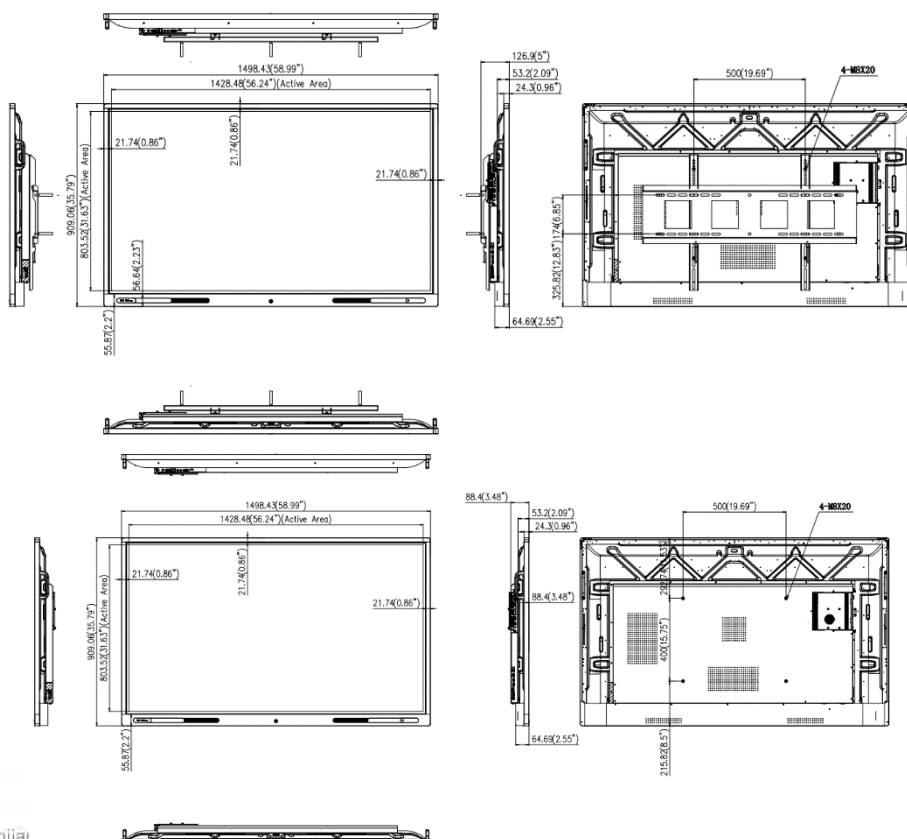

Headquarters

No.555 Qianmo Road, Binjia
Hangzhou 310051, China
T +86-571-8807-5998
www.hikvision.com

Follow us on social media to get the latest product and solution information.



Hikvision



HikvisionHQ



HikvisionHQ



Hikvision_Global



Hikvision
Corporate Channel



hikvisionhq

